

The Poetics of Gourmet 奉食主義

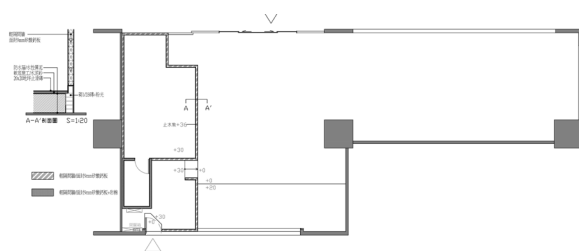

Regarding a hot pot gourmet restaurant located in the station, the designer thinks that the transparency and concealment of the dining space must be combined to attract the continuous flowing of guests, and to allow guests to enjoy dining in the comforting space. The designer uses many white materials, hollow board, glass, and iron metal mesh to plan the spaciousness between the seats. In addition, the designer uses simple colors to activate clean space, such as the art of installations made with hand-crafted plant decorations combined with unique cookware, and posters with food on the walls.



< partition wall plan
partition wall plan >

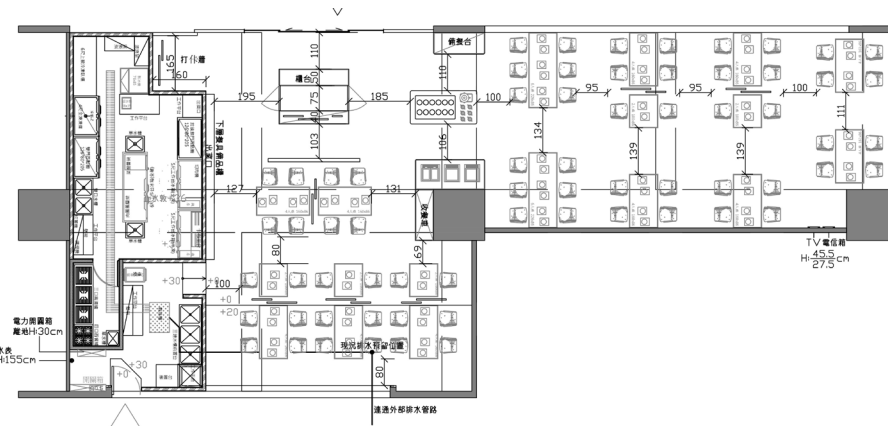

shop design data

地點：台灣屏東市
空間形式：商業空間（臺灣屏東火車站商場店舖）
施工期：：二個半月
完工期：2019.1
室內坪數：62 坪
材質：耐燃一級美耐板、中空板、磁磚、PVC 地磚、
鐵件金屬網、灰泥樂土、人造植物

description

火鍋餐廳位於車站大廳內，居臨十多家餐飲空間旁，周圍不斷有移動人潮。我們將它定義為一處可讓人入內飽食、身體與視覺暫獲舒緩、解放的餐飲空間，因而以具有淨空感的灰白色系為基調，一來與其他五花八門的店家風格有所區分，二則將鮮色欲滴的肉品主食烘托而出，同時用以俐落整塑用餐區、行走動線與烹飪區。

以若隱若現的中空板與透明清玻作為內外隔窗，上下接連鐵件金屬網，視覺通透感延伸至室內，以吸引過路客目光，也讓在內用餐的客人有半遮蔽的隱私感。室內天地壁以白、灰色階調配，以應選材上的輕盈與潔淨。特別在大牆面上，以手工花藝綠化植物結合該店家特製的鍋蓋，懸掛如畫作，如身置於藝廊，亦在攏高的座位區窗緣，沿縫置入一排永生綠植栽，適時以綠意染化。

餐桌椅、料理檯面與收納櫃，以及看得見的管線縱橫與看不見的迴路整合，複雜的元素紛陳，像是奏鳴曲，此起彼落，卻輕重有序。座位區靠牆，中間是供食走道，間距寬敞，隔間以懸掛式及半立地式的深灰中空版微微暗示座位，外露的燈具與管線，整束在挑高的天花上。全室水平垂直線條，不斷交錯延伸至底，磨石子塑膠地板接縫以鑲金條收尾，輕快的節奏一躍而出，在冷靜的環覆中，活潑化了用餐氛圍。

The hotpot restaurant is located in the lobby of the railway station. We define the restaurant as a place for people to eat and relax their eyes and bodies. Therefore the basic color scheme of the interior is light grey to distinguish it from other shops while providing strong contrasts for the color of fresh foods with clear divisions of the dining area, walkways, and the kitchen.

Translucent panels and clear glass panel serve as the dividing windows between inside and outside. The metal screens and their components attract the sight lines of passengers while providing appropriate privacy for the consumers. The white and grey colors of the floor and ceiling of the interior match the clean and airy materiality. Hanging on the main wall are the hand-crafted plant decorations combined with unique cookware as if paintings in a gallery exhibition. The evergreen plants line up on the raised seating area by the window.

The integration of vertical and horizontal lines on the tables, chairs, countertops, and cabinets strikes the chords of forte and pianoforte like a sonata. The seating area is placed next to the wall. The spacious central walkway is for serving the foods. The dark grey panels hanging on the ceiling, where light fixtures and pipelines are collected, echo the seating below. The constantly intersecting horizontal and vertical lines extend from the ceiling to the floor. The embedded copper inlays on the terrazzo flooring accentuate the serene surrounding and enliven the atmosphere of the dining space.



The Poetics of Gourmet

奉食主義







The Poetics of Gourmet





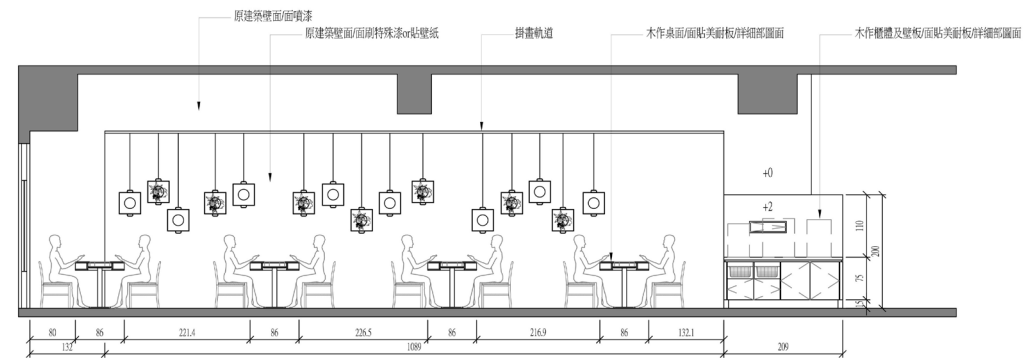

wall decoration

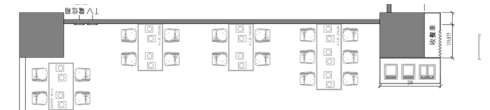

[illegible]