

The image shows a large, modern interior space. The ceiling is a complex, white, undulating structure with a grid of thin, gold-colored lines. On the left, numerous vertical, gold-colored rods of varying lengths hang from the ceiling. In the center, a wireframe sculpture of a horse in mid-gallop is suspended. The floor is made of light-colored wood, and a wide staircase with a dark metal railing leads up from the foreground. On the right, a multi-story building with a grid of windows is visible. The overall atmosphere is one of sophisticated, contemporary design.

THE U WORLD CLUB HOUSE

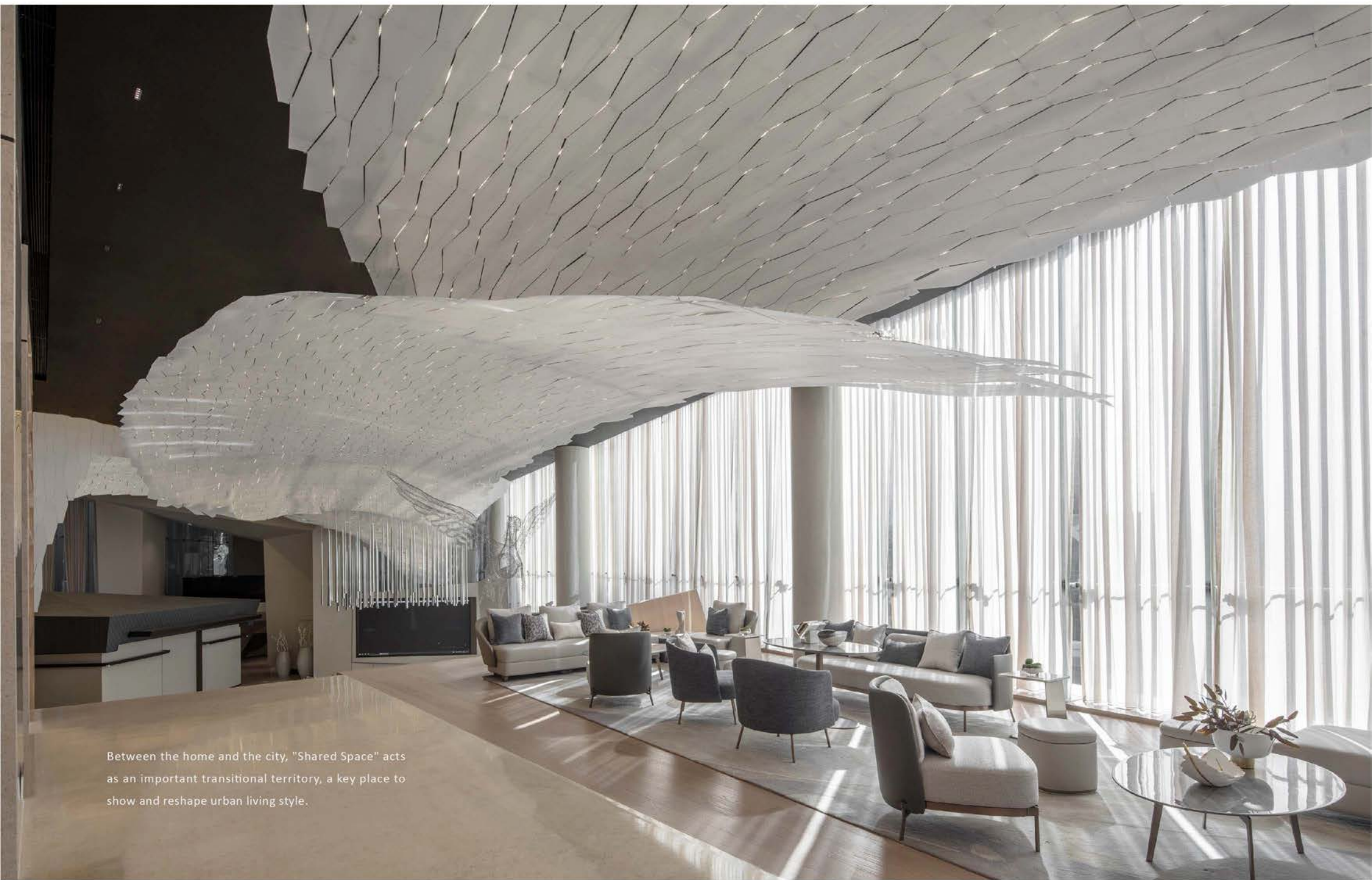

Between the home and the city, "Shared Space" acts as an important transitional territory, a key place to show and reshape urban living style.



This is a space with the theme of reading and also a social platform with coffee experience as the carrier. A systematic, diversified and upgraded "shared cultural experience space" integrating reading, coffee and cultural lifestyle.



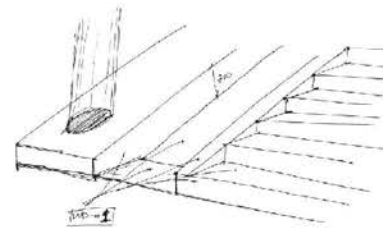
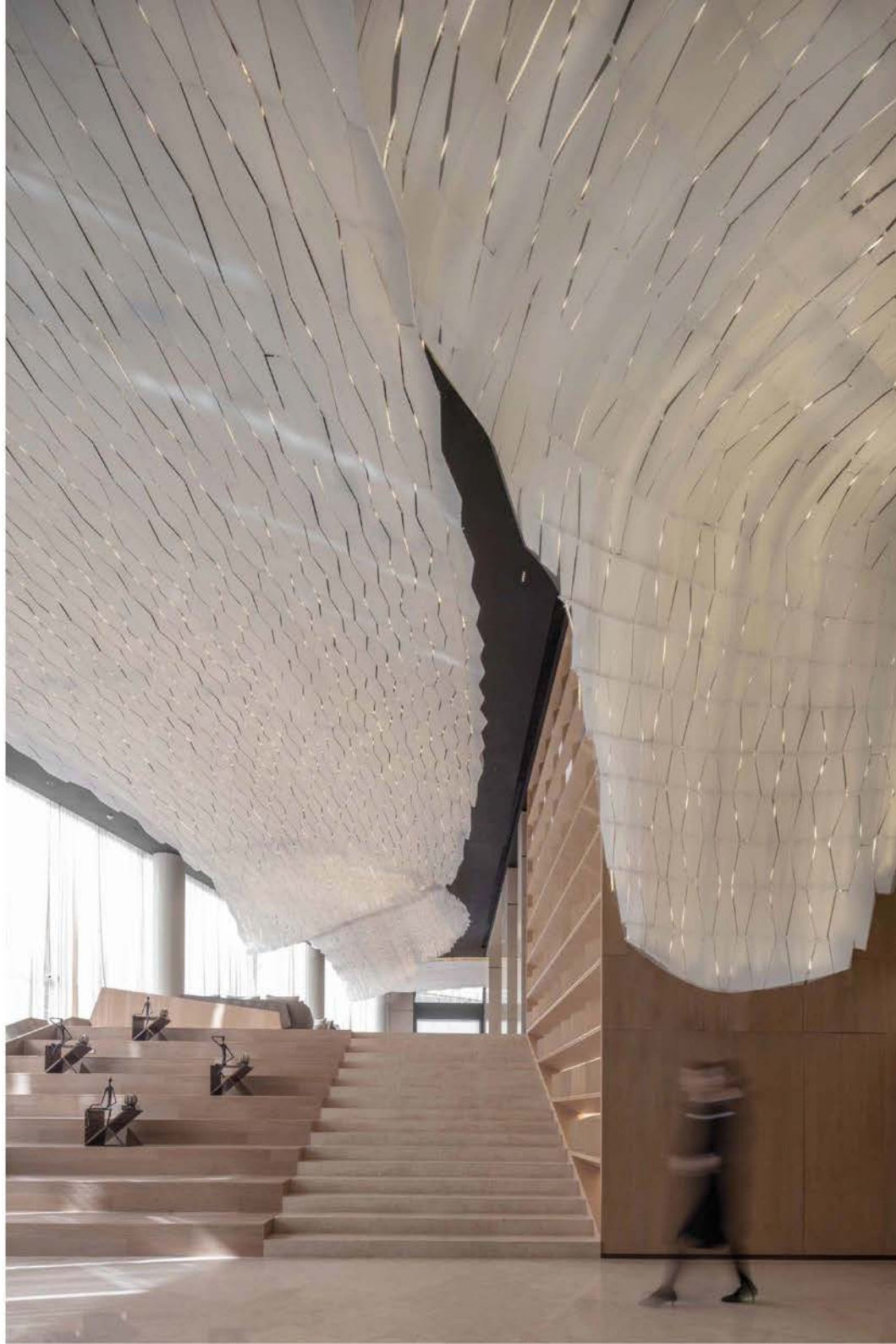

Lots of light is led in and pours down along the great steps, and the transparent view of the glass curtain wall also bring the natural beauty of the park. The high wall bookshelves contain the fragrance of books, forming a towering space like a dense forest.

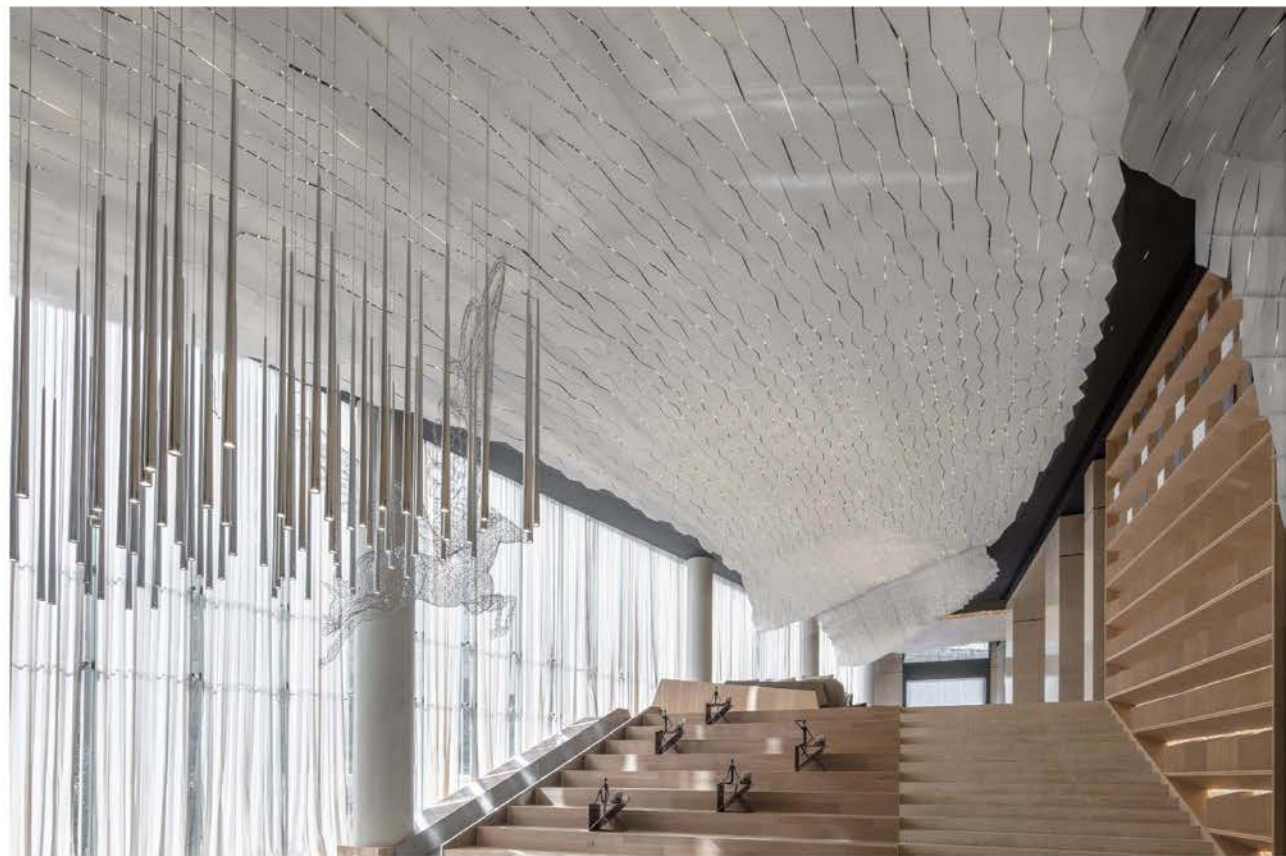

The art installation above the step reading area is made of illuminated geometric polygonal acrylic splicing, like a river in heaven and a silver bay in dawn. The reading area will undoubtedly become a mecca for its literary style.



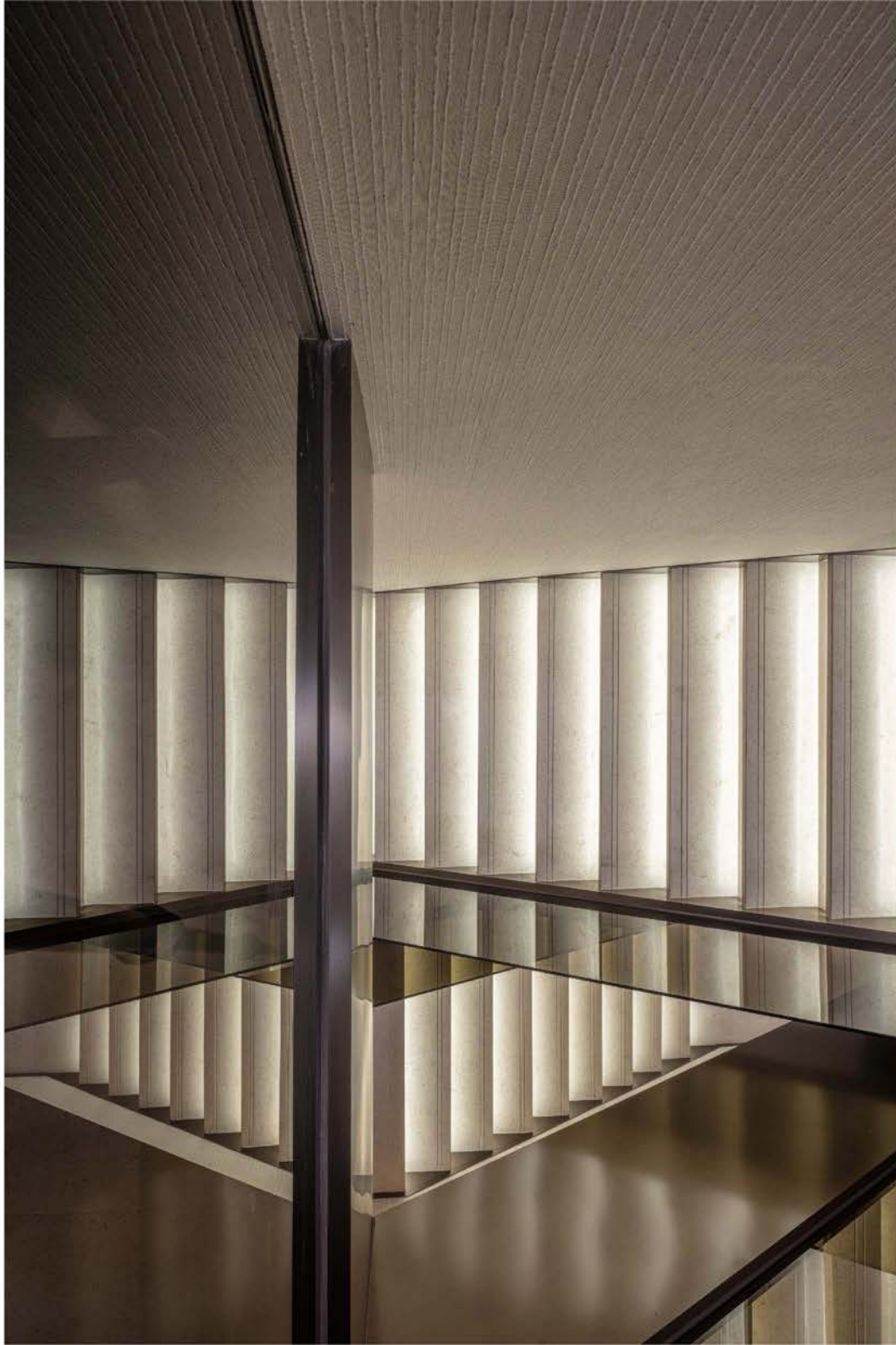

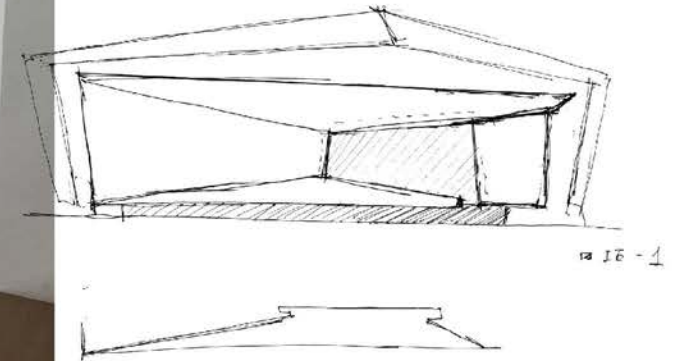

The design adopts the change of broken line wall and the continuity of irregular volume throughout the whole space. When you walk through the space, the path winds through high peaks, fully arouse the hiding and exposing of the space, so that the space here shows multi-level visual changes, thus forming a spatial dislocation of the travel experience.



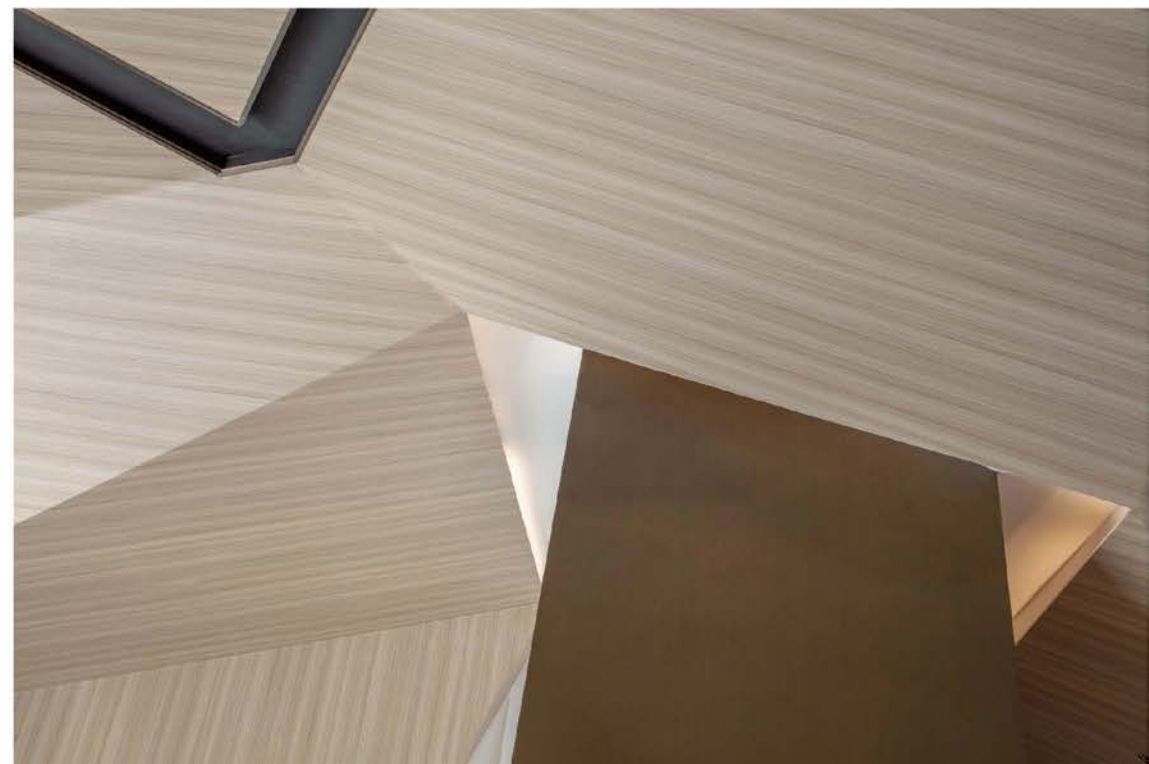
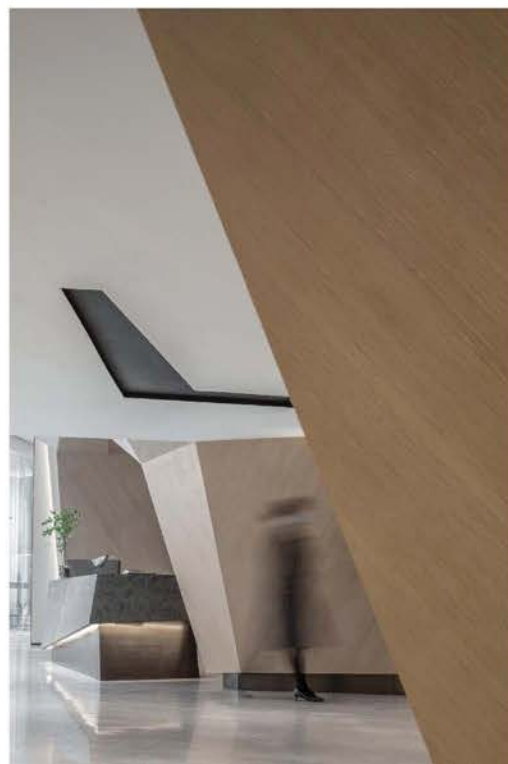

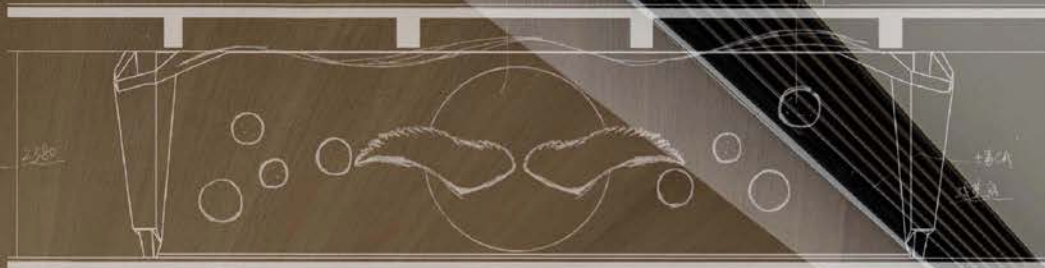

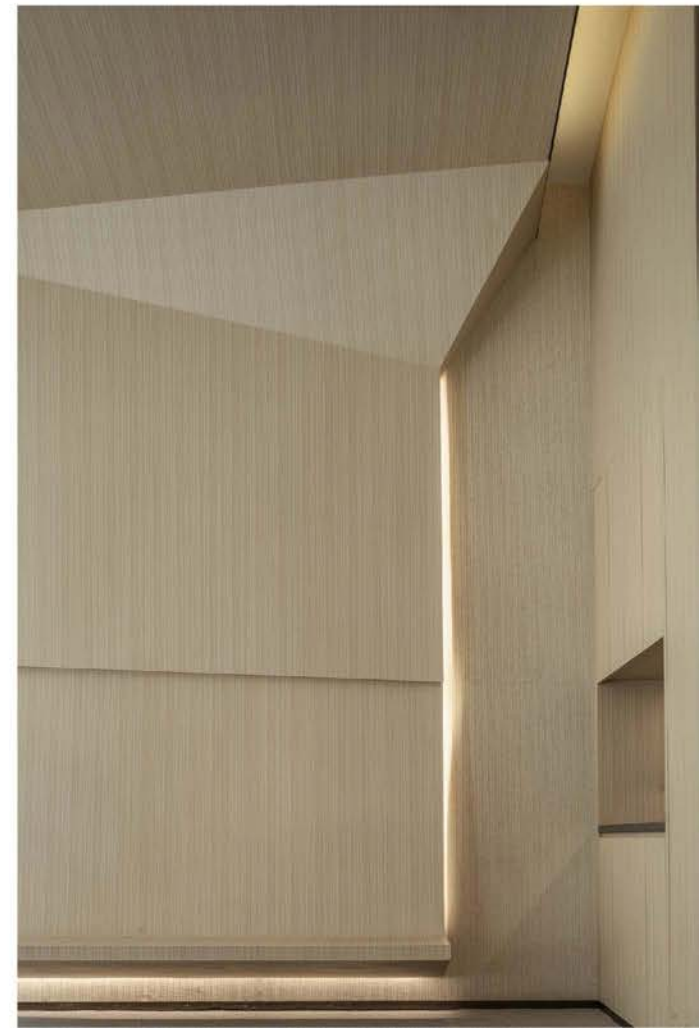

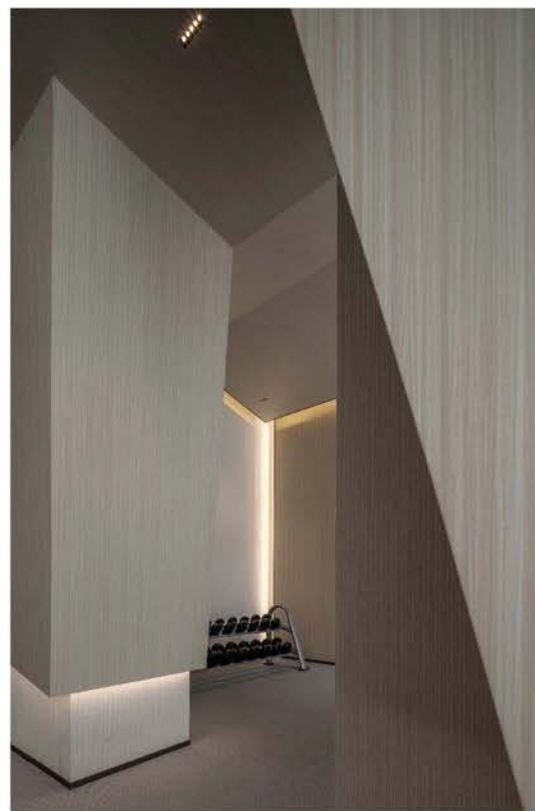

With the continuous deepening of the concept of healthy life, fitness, as one of the important forms of "active health", has received more and more attention from people. The boundaries are appropriately set within the constraints of the building structure of the original underground space, while the continuity of the space can be felt by visiting along the "corridors" of the space.



Companionship and communication is an important part of the parent-child relationship. The design of parent-child space creates an interesting place for parent-child interaction activities such as baking, painting, performance, animation theater, and so on. From continuous humanized care to emotional upgrade iteration, design makes each fine and micro scene construction, and easily achieve the beautiful imagination of life.

