

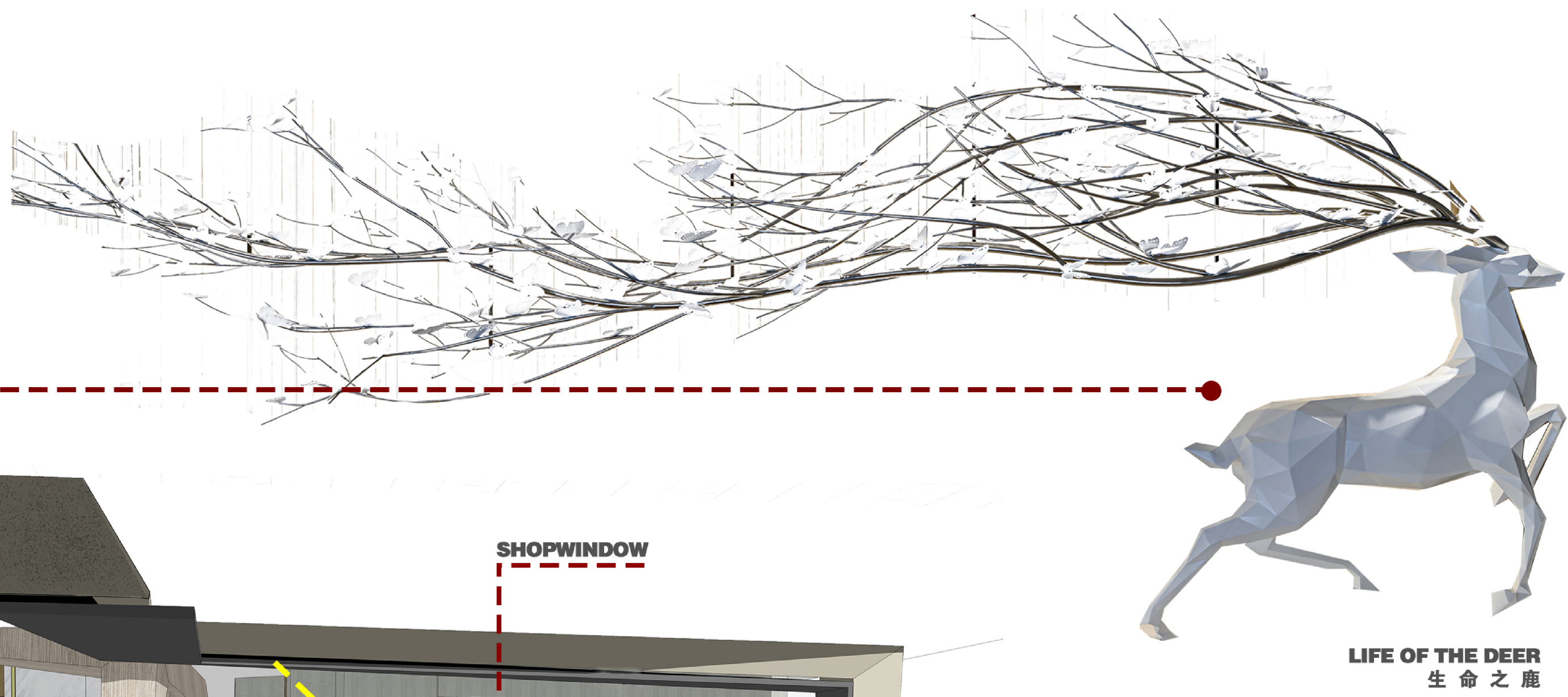

LOCATION **D1**
HISTORICAL BACKGROUND

This case is located in the bustling area of central Shanghai. Since the 1990s, together with Xujiahui, it has been the two major urban sub-centers, adjacent to the commercial center of Jing'an Temple. At the same time, relying on the natural landscape of Zhongshan Park, it is a key planning and development area in Shanghai. The designers intend to combine art, and ecology into modern space, so as to create a reception center with a vibrant and artistic atmosphere. The project is divided into two floors, the first floor is the hall display area and the conversation area, and the second floor is the VIP reception and office area.

D2 CONCEPT
SHOWCASE-VISUAL CONNECTION, BREAKING BOUNDARIES

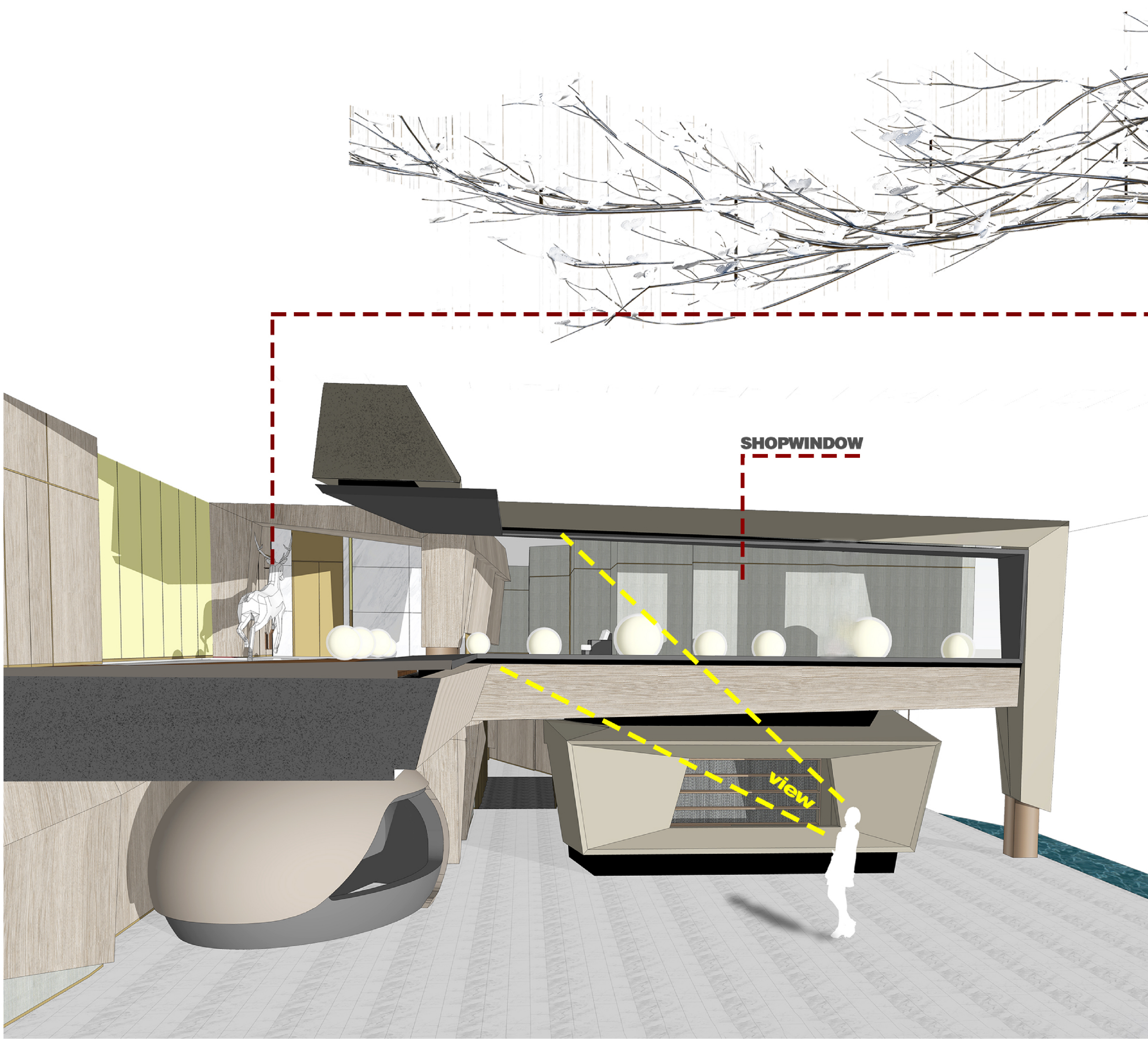

A 6-meter-long art installation, "Deer of Life", is set up in the second-floor window area. Guests can appreciate this mysterious "deer" through the window on the first floor. In the process of "seeking the deer", the effects of interspersed scenery are produced visually, and different scenes will be presented if one goes further steps, so as to achieve space-to-space communication and dialogue between people and space.

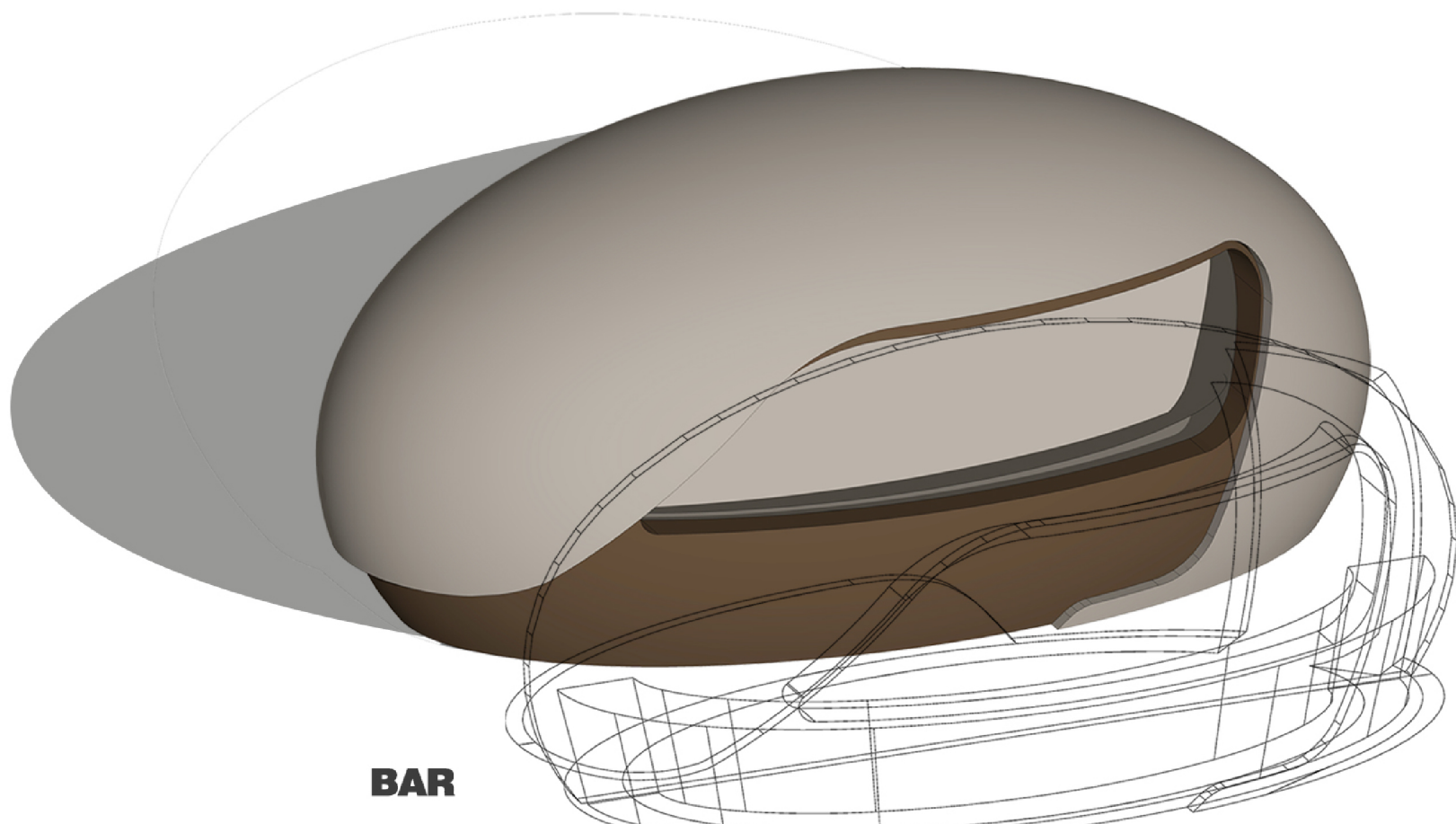
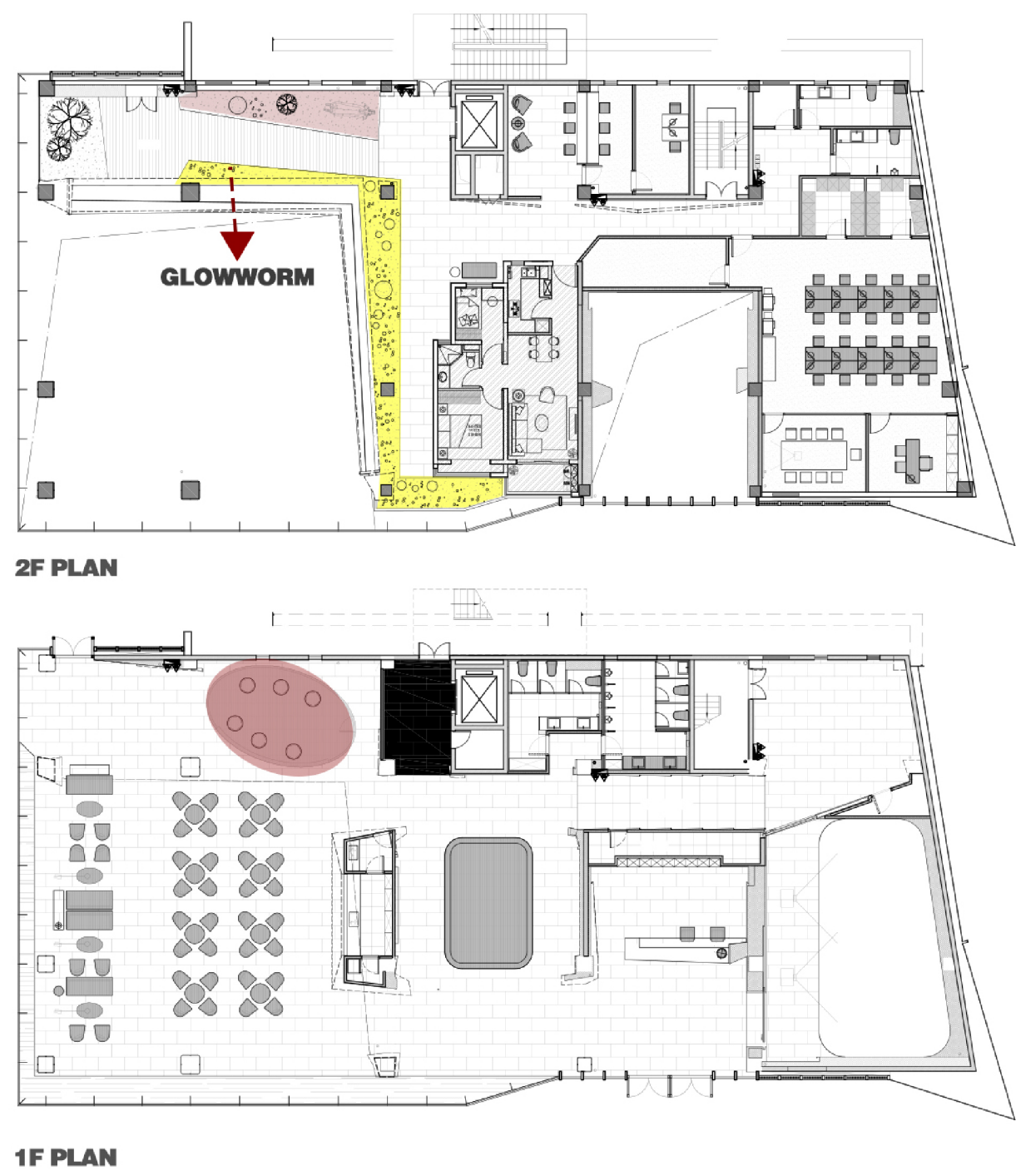

作品名稱	SEEKING DEER		
創作時間	2019.8	設計者姓名	凌子達
職業	設計總監	公司名稱	KLID達觀國際設計事務所